



TE Connectivity

Product Change Notification: E-21-003104

PCN Date: 17-MAY-21

TE would like to inform you of the following change(s) to the listed TE Connectivity Product. In case of any further questions about this change(s), please contact your TE Connectivity Sales Engineer. Affected part, drawing and/or specification numbers are listed on the attached sheet(s).

General Product Description:

T9A series relay

Description of Changes

Change UL agency approval mark from RU to cRUus, and remove CSA mark. Product still meet two standards UL508 and CSA C22.2 NO.14-13. no any function and performance change, only appearance marking change.

Marking change compare

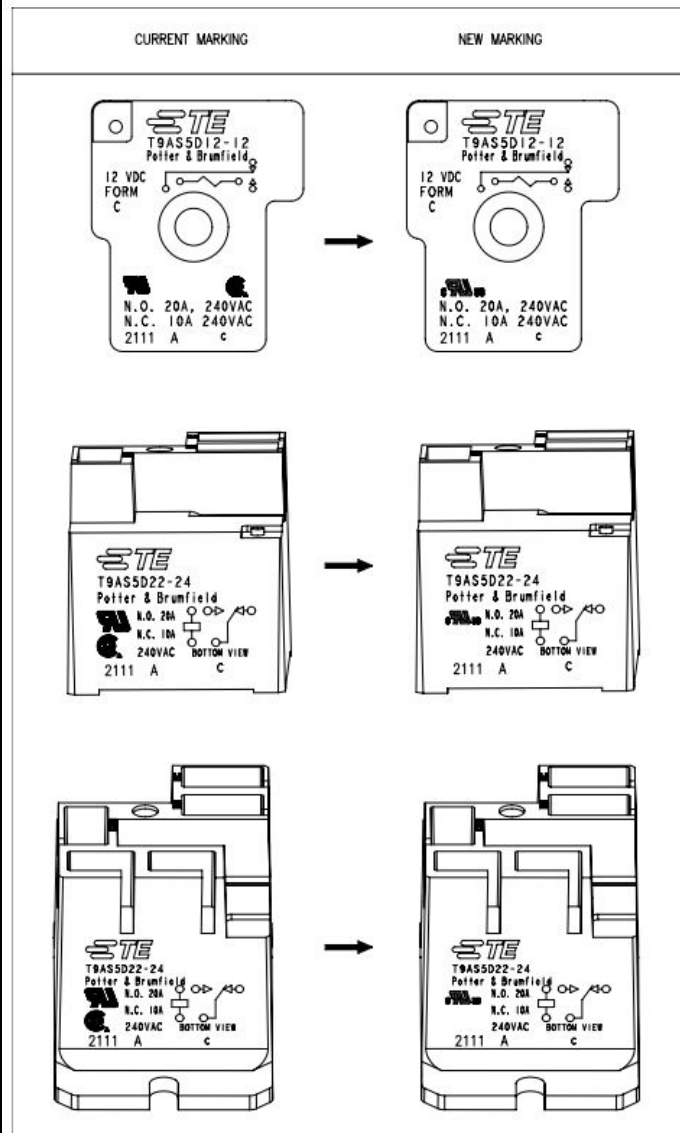

Other attachments:

[Marking change compare](#)

Reason for Changes:

Manufacturing / Process Requirements. Product agency approval marking optimization.

Estimated Dates:

Last Order Date (Obsolete Parts Only):	First Date To Ship (Changed Parts Only):
	08-OCT-2021
Last Ship Date (Obsolete Parts Only):	Last Date for Mixed Shipments: (Changed Parts Only):
	30-NOV-2021

Part Number(s) being Modified:

Part Number	Part Discontinued per PCN	Customer Drawing	Customer Part Number	Alias Part Number(s)	Substitute Part Number	Substitute Alias Part Number(s)	Description Of Difference
1-1393210-2	NO			"T9AS1D12-110"			
1-1393210-3	NO			"T9AS1D12-12"			
1-1393210-4	NO			"T9A-S1D12-15", "T9AS1D12-15"			
1-1393210-5	NO			"T9AS1D12-18"			
1-1393210-8	NO		PB303-ND	"AMP-1-1393210-8", "F07854-000", "T9AS1D12-24"			
1-1419104-7	NO			"T9A-S1D22-12", "T9AS1D22-12"			
1-1423091-8	NO			"T9AV1L12-12"			
1423091-6	NO			"T9AV5L12-12"			
1423091-9	NO			"T9AV1D22-12"			
2-1393210-0	NO			"T9AS1D12-5"			
2-1393210-2	NO			"T9AS1D12-9"			
2-1393210-5	NO			"T9AS1L12-24"			
2-1393212-6	NO			"T9A-S5L22-12", "T9AS5L22-12"			
2-1419104-1	NO			"T9AS1D22-24"			
2-1419104-2	NO			"T9AS1D22-48"			
2-1419104-3	NO			"T9AS1D22-5"			
2-1419104-5	NO			"T9A-S1L22-12", "T9AS1L22-12"			
2-1419104-6	NO			"T9AS1L22-18"			
2-1423091-3	NO			"T9AV1D22-48"			
3-1393210-2	NO			"T9A-S5D12-110", "T9AS5D12-110"			
3-1393210-3	NO			"T9AS5D12-12"			
3-1393210-4	NO			"T9A-S5D12-18", "T9AS5D12-18"			
3-1419104-2	NO			"T9AS5D22-110"			
3-1419104-3	NO		PB308-ND	"T9A-S5D22-12", "T9AS5D22-12"			
3-1419104-4	NO			"T9A-S5D22-18", "T9AS5D22-18"			
3-1419104-6	NO		PB309-ND	"T9A-S5D22-24", "T9AS5D22-24"			
3-1419104-9	NO			"T9AS5D22-5"			
4-1393210-0	NO			"T9AS5D12-9"			
4-1393210-1	NO			"T9AS5L12-12"			
4-1393210-2	NO			"T9A-S5L12-24", "T9AS5L12-24"			
4-1393210-4	NO			"T9AV1D12-22"			
4-1393210-6	NO			"T9AV5D12-22"			
4-1419104-0	NO			"T9AS5L22-18"			
4-1419104-2	NO			"T9A-V1L22-24", "T9AV1L22-24"			
4-1419104-3	NO			"T9AV5L22-24"			
4-1419148-7	NO			"T9AV1D12-9"			
5-1419102-2	NO			"T9A-P5D52-24", "T9AP5D52-24"			
5-1419102-4	NO		PB310-ND	"T9A-P5D52-12", "T9AP5D52-12"			
5-1419102-5	NO			"T9AP5D52-110"			
5-1419102-7	NO			"T9AP1D52-48-01"			
5-1419102-8	NO			"T9AP1D52-48"			
5-1419102-9	NO			"T9AP1D52-36-01"			
5-1423091-7	NO			"T9AS1D14-12"			
6-1419102-0	NO			"T9AP1D52-12"			
6-1419102-3	NO			"T9AP1D52-24"			
6-1419102-4	NO			"T9AP5D52-48"			
6-1419102-8	NO			"T9A-P1D52-9", "T9AP1D52-9"			
6-1423091-3	NO			"T9AS1D14-24"			
7-1423091-0	NO			"T9AS5D24-12"			

Part Number(s) being Modified:

Part Number	Part Discontinued per PCN	Customer Drawing	Customer Part Number	Alias Part Number(s)	Substitute Part Number	Substitute Alias Part Number(s)	Description Of Difference
1-1393210-2	NO			"T9AS1D12-110"			
1-1393210-3	NO			"T9AS1D12-12"			
1-1393210-4	NO			"T9A-S1D12-15", "T9AS1D12-15"			
1-1393210-5	NO			"T9AS1D12-18"			
1-1393210-8	NO		PB303-ND	"AMP-1-1393210-8", "F07854-000", "T9AS1D12-24"			
1-1419104-7	NO			"T9A-S1D22-12", "T9AS1D22-12"			
1-1423091-8	NO			"T9AV1L12-12"			
1423091-6	NO			"T9AV5L12-12"			
1423091-9	NO			"T9AV1D22-12"			
2-1393210-0	NO			"T9AS1D12-5"			
2-1393210-2	NO			"T9AS1D12-9"			
2-1419104-1	NO			"T9AS1D22-24"			
2-1419104-3	NO			"T9AS1D22-5"			
3-1393210-3	NO			"T9AS5D12-12"			
3-1419104-2	NO			"T9AS5D22-110"			
3-1419104-3	NO		PB308-ND	"T9A-S5D22-12", "T9AS5D22-12"			
3-1419104-6	NO		PB309-ND	"T9A-S5D22-24", "T9AS5D22-24"			
3-1419104-9	NO			"T9AS5D22-5"			
4-1393210-1	NO			"T9AS5L12-12"			
4-1393210-2	NO			"T9A-S5L12-24", "T9AS5L12-24"			
4-1393210-4	NO			"T9AV1D12-22"			
4-1393210-6	NO			"T9AV5D12-22"			
5-1419102-2	NO			"T9A-P5D52-24", "T9AP5D52-24"			

Part Number	Part Discontinued per PCN	Customer Drawing	Customer Part Number	Alias Part Number(s)	Substitute Part Number	Substitute Alias Part Number(s)	Description Of Difference
5-1419102-4	NO		PB310-ND	"T9A-P5D52-12", "T9AP5D52-12"			
5-1419102-8	NO			"T9AP1D52-48"			
5-1419102-9	NO			"T9AP1D52-36-01"			
6-1419102-0	NO			"T9AP1D52-12"			
6-1419102-3	NO			"T9AP1D52-24"			

Part Number(s) being Modified:

Part Number	Part Discontinued per PCN	Customer Drawing	Customer Part Number	Alias Part Number(s)	Substitute Part Number	Substitute Alias Part Number(s)	Description Of Difference
2-1419104-1	NO			"T9AS1D22-24"			

Part Number(s) being Modified:

Part Number	Part Discontinued per PCN	Customer Drawing	Customer Part Number	Alias Part Number(s)	Substitute Part Number	Substitute Alias Part Number(s)	Description Of Difference
1-1423091-8	NO			"T9AV1L12-12"			
2-1393210-5	NO			"T9AS1L12-24"			
2-1393212-6	NO			"T9A-S5L22-12", "T9AS5L22-12"			
2-1419104-2	NO			"T9AS1D22-48"			
2-1419104-5	NO			"T9A-S1L22-12", "T9AS1L22-12"			
2-1419104-6	NO			"T9AS1L22-18"			
2-1423091-3	NO			"T9AV1D22-48"			
3-1393210-2	NO			"T9A-S5D12-110", "T9AS5D12-110"			
3-1393210-4	NO			"T9A-S5D12-18", "T9AS5D12-18"			
3-1419104-4	NO			"T9A-S5D22-18", "T9AS5D22-18"			

Part Number	Part Discontinued per PCN	Customer Drawing	Customer Part Number	Alias Part Number(s)	Substitute Part Number	Substitute Alias Part Number(s)	Description Of Difference
4-1393210-2	NO			"T9A-S5L12-24", "T9AS5L12-24"			
4-1419104-0	NO			"T9AS5L22-18"			
4-1419104-2	NO			"T9A-V1L22-24", "T9AV1L22-24"			
4-1419104-3	NO			"T9AV5L22-24"			
4-1419148-7	NO			"T9AV1D12-9"			
5-1419102-5	NO			"T9AP5D52-110"			
5-1423091-7	NO			"T9AS1D14-12"			
6-1419102-4	NO			"T9AP5D52-48"			
6-1419102-8	NO			"T9A-P1D52-9", "T9AP1D52-9"			
6-1423091-3	NO			"T9AS1D14-24"			

Part Number(s) being Modified:

Part Number	Part Discontinued per PCN	Customer Drawing	Customer Part Number	Alias Part Number(s)	Substitute Part Number	Substitute Alias Part Number(s)	Description Of Difference
1-1423091-8	NO			"T9AV1L12-12"			
2-1393210-5	NO			"T9AS1L12-24"			
2-1393212-6	NO			"T9A-S5L22-12", "T9AS5L22-12"			
2-1419104-2	NO			"T9AS1D22-48"			
2-1419104-5	NO			"T9A-S1L22-12", "T9AS1L22-12"			
2-1419104-6	NO			"T9AS1L22-18"			
2-1423091-3	NO			"T9AV1D22-48"			
3-1393210-2	NO			"T9A-S5D12-110", "T9AS5D12-110"			
3-1393210-4	NO			"T9A-S5D12-18", "T9AS5D12-18"			

Part Number	Part Discontinued per PCN	Customer Drawing	Customer Part Number	Alias Part Number(s)	Substitute Part Number	Substitute Alias Part Number(s)	Description Of Difference
3- 1419104-4	NO			"T9A-S5D22-18", "T9AS5D22-18"			
4- 1393210-2	NO			"T9A-S5L12-24", "T9AS5L12-24"			
4- 1419104-0	NO			"T9AS5L22-18"			
4- 1419104-2	NO			"T9A-V1L22-24", "T9AV1L22-24"			
4- 1419104-3	NO			"T9AV5L22-24"			
4- 1419148-7	NO			"T9AV1D12-9"			
5- 1419102-5	NO			"T9AP5D52-110"			
5- 1423091-7	NO			"T9AS1D14-12"			
6- 1419102-4	NO			"T9AP5D52-48"			
6- 1419102-8	NO			"T9A-P1D52-9", "T9AP1D52-9"			
6- 1423091-3	NO			"T9AS1D14-24"			

Part Number(s) being Modified:

Part Number	Part Discontinued per PCN	Customer Drawing	Customer Part Number	Alias Part Number(s)	Substitute Part Number	Substitute Alias Part Number(s)	Description Of Difference
2- 1393210-5	NO			"T9AS1L12-24"			
2- 1393212-6	NO			"T9A-S5L22-12", "T9AS5L22-12"			
2- 1419104-1	NO			"T9AS1D22-24"			
2- 1419104-5	NO			"T9A-S1L22-12", "T9AS1L22-12"			
3- 1393210-2	NO			"T9A-S5D12-110", "T9AS5D12-110"			
3- 1419104-3	NO			"T9A-S5D22-12", "T9AS5D22-12"			
4- 1393210-2	NO			"T9A-S5L12-24", "T9AS5L12-24"			
4- 1419104-2	NO			"T9A-V1L22-24", "T9AV1L22-24"			

Part Number	Part Discontinued per PCN	Customer Drawing	Customer Part Number	Alias Part Number(s)	Substitute Part Number	Substitute Alias Part Number(s)	Description Of Difference
4-1419104-3	NO			"T9AV5L22-24"			
5-1419102-2	NO			"T9A-P5D52-24", "T9AP5D52-24"			
5-1419102-4	NO			"T9A-P5D52-12", "T9AP5D52-12"			
6-1423091-3	NO			"T9AS1D14-24"			
7-1423091-0	NO			"T9AS5D24-12"			

Part Number(s) being Modified:

Part Number	Part Discontinued per PCN	Customer Drawing	Customer Part Number	Alias Part Number(s)	Substitute Part Number	Substitute Alias Part Number(s)	Description Of Difference
1-1393210-3	NO			"T9AS1D12-12"			
1-1419104-7	NO			"T9A-S1D22-12", "T9AS1D22-12"			
2-1419104-1	NO			"T9AS1D22-24"			
4-1393210-0	NO			"T9AS5D12-9"			
5-1419102-7	NO			"T9AP1D52-48-01"			
6-1419102-0	NO			"T9AP1D52-12"			

Part Number(s) being Modified:

Part Number	Part Discontinued per PCN	Customer Drawing	Customer Part Number	Alias Part Number(s)	Substitute Part Number	Substitute Alias Part Number(s)	Description Of Difference
1-1423091-8	NO			"T9AV1L12-12"			
2-1393210-5	NO			"T9AS1L12-24"			
2-1393212-6	NO			"T9A-S5L22-12", "T9AS5L22-12"			
2-1419104-1	NO			"T9AS1D22-24"			
2-1419104-5	NO			"T9A-S1L22-12", "T9AS1L22-12"			

Part Number	Part Discontinued per PCN	Customer Drawing	Customer Part Number	Alias Part Number(s)	Substitute Part Number	Substitute Alias Part Number(s)	Description Of Difference
3- 1393210-2	NO			"T9A-S5D12-110", "T9AS5D12-110"			
3- 1419104-3	NO		PB308-ND	"T9A-S5D22-12", "T9AS5D22-12"			
4- 1393210-2	NO			"T9A-S5L12-24", "T9AS5L12-24"			
4- 1419104-2	NO			"T9A-V1L22-24", "T9AV1L22-24"			
4- 1419104-3	NO			"T9AV5L22-24"			
4- 1419148-7	NO			"T9AV1D12-9"			
5- 1419102-2	NO			"T9A-P5D52-24", "T9AP5D52-24"			
5- 1419102-4	NO		PB310-ND	"T9A-P5D52-12", "T9AP5D52-12"			
6- 1419102-4	NO			"T9AP5D52-48"			
6- 1419102-8	NO			"T9A-P1D52-9", "T9AP1D52-9"			
6- 1423091-3	NO			"T9AS1D14-24"			
7- 1423091-0	NO			"T9AS5D24-12"			

CURRENT MARKING

NEW MARKING

